

FieldConxTM Fiber Optic Field-Installable Connectors and Tools

Installation Instructions

SC Universal Type

Tools Needed:



****Note:** Connector, tail boots, pusher, and dust free wipe are included when purchasing the connector. Our other tools and supplies are sold separately.

For Drop Cable



Step 1: Put boot on cable.

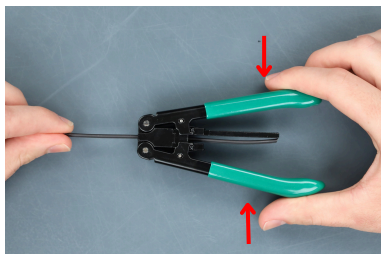

Step 2: Insert the cable in the drop cable stripper to at least the 5cm mark and strip the jacket from the fiber.

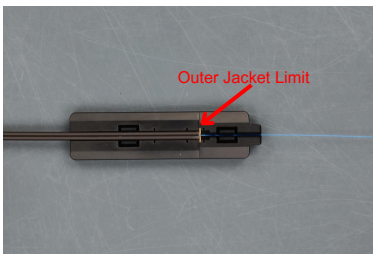

Step 3: Fix the cable into the cutting jig. The outer jacket must meet the outer jacket limit.

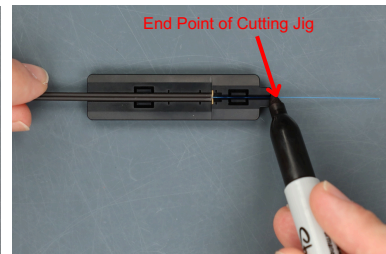

Step 4: Mark the 250µm acrylate at the end point of the cutting jig.



Step 5: Strip off the 250µm acrylate coating back to the added mark—stripping off the mark in the process.

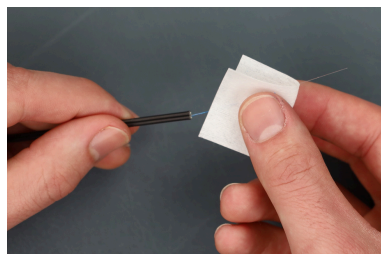

Step 6: Clean the fiber with dust-free wipe.



Step 7: Fix the cable into the cutting jig. The outer jacket must meet the outer jacket limit. The 250µm acrylate coating should meet the end of the cutting jig.



Step 8: Slide the cutting jig in the holder slot of the cleaver until it meets the clamp pad. Cleave fiber.

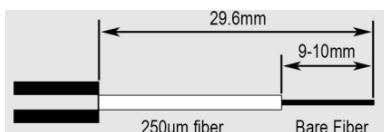

Note: The appropriate lengths of fiber and jacketing after cleaving.

****Photo Not to Scale**

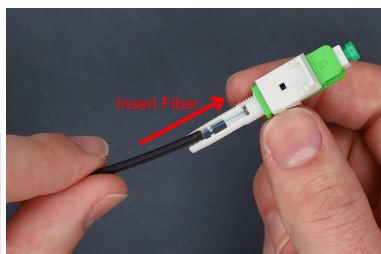

Step 9: Press the opener firmly and insert the fiber into the connector until the fibers meet inside—you'll feel resistance. Push the drop cable jacket into the slot with teeth at the base of the connector.

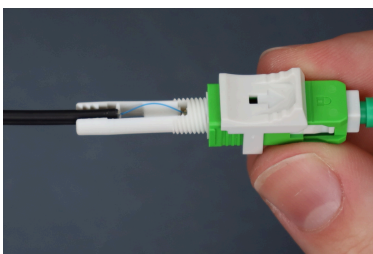

Note: There should be a slight bend in the fiber.

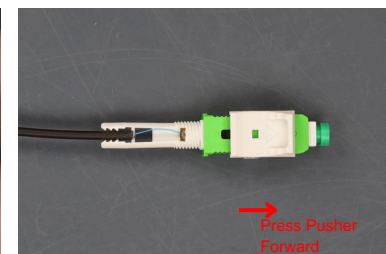

Step 10: Press the pusher forward to lock the fiber.

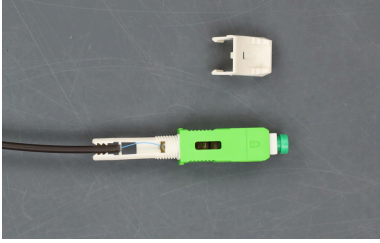

Step 11: Remove the pusher.

****Note:** Do NOT discard the pusher¹



Step 12: Screw the boot up all the way to complete the assembly.

¹ - Connectors can be re-terminated at least 3 times.